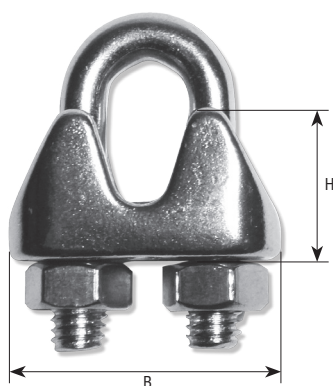
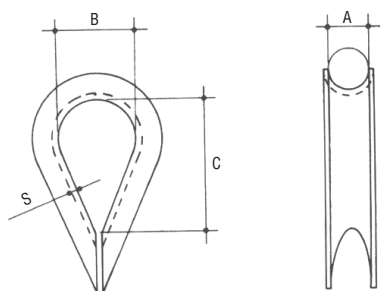

**Art. 3070**
**MORSETTI A CAVALLOTTO**
**AISI 316**

Articolo	D mm	B mm	H mm	L mm	PESO g/cad
3070A	2	16	10	11	8
3070B	3	18	11	11	9
3070C	4	21	13	12	13
3070D	5	25	15	15	23
3070E	6	28	17	18	39
3070F	8	31	20	18	54
3070G	10	38	23	22	93
3070H	12-13	47	25.5	30	174
3070L	16	54	32	34	225
3070M	18-19	62	38	36	229
3070N	22	64	43.5	40	423

**Art. 3090**
**REDANCE**
**AISI 316**

Articolo	A mm	B mm	C mm	S mm	PESO g/cad
3090A	2	7	10	0.7	3
309025	2.5	8	14	0.7	2
3090B	3	9	15	1	6
3090C	4	11	18	1	8
3090D	5	14	20	1.2	10
3090E	6	15	23	1.2	10
3090F	8	18	29	1.5	20
3090G	10	24	37	1.5	30
3090H	12	29	50	1.5	40
3090J	14	33	54	2	80
3090K	16	37	64	2	120
3090L	18	40	70	2.5	150
3090M	20	45	75	2.5	180
3090N	23	45	78	2.5	190
3090P	25	49	79	2.5	210
3090Q	28	60	105	3	360
3090R	30	65	115	3	420
3090S	32	73	128	4	710

**ACCESSORI NAUTICI INOX**