

Art. 3044

ANELLI DI FERMO

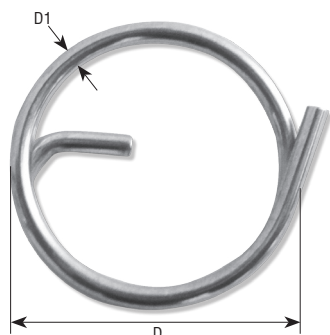

Articolo	D1 mm	D mm
3044C	1	11
3044D	1.25	15
3044E	1.5	19
3044F	2	23

Art. 3050

MORSETTI SIMPLEX

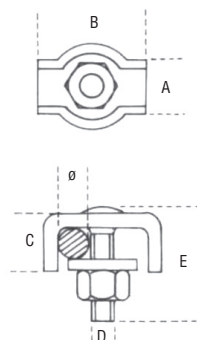

Articolo	Ø mm	A mm	B mm	C mm	D mm	E mm	PESO g/cad
3050A	2	8	17	5	M4	13.5	5
3050B	3	9	17	5	M4	13	7
3050C	4	13	21	7	M5	17	13
3050D	5	14	25	8	M5	18	17
3050E	6	17	30	9.5	M6	22	25
3050F	8	22	38.5	10.0	M8	25	52
3050G	10	26.5	47	13	M10	31	92

Art. 3060

MORSETTI DUPLEX

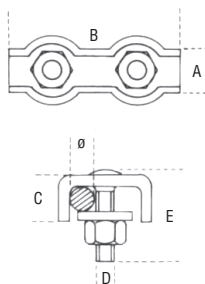

Articolo	Ø mm	A mm	B mm	C mm	D mm	E mm	PESO g/cad
3060A	2	7	30	5	M4	14	10
3060B	3	10	35	7	M4	14	14
3060C	4	12	42	7	M5	17	25
3060D	5	13	50	8.5	M5	18	34
3060E	6	16	60	9.5	M6	22	50
3060F	8	22	75	10	M8	29	104
3060G	10	26.5	95	13	M10	32	180