

AISI 316

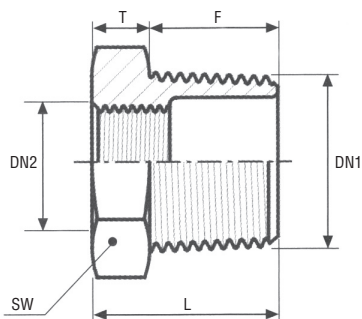

Articolo	DN1 inch	DN2 inch	L mm	T mm	F mm	SW mm	PESO g/cad
1320A	1/4"	1/8"	15.2	4.4	10.8	16	10
1320B	3/8"	1/8"	16.5	4.1	12.4	18	19
1320C	3/8"	1/4"	16.5	4.6	11.9	18	14
1320D	1/2"	1/4"	21	5.4	15.6	26	40
1320E	1/2"	3/8"	21	5.6	15.4	26	34
13203414	3/4"	1/4"	24	6.4	17.6	30	71
1320F	3/4"	3/8"	24	6.6	17.4	30	65
1320G	3/4"	1/2"	24	6.5	17.5	30	54
1320H	1"	1/2"	27	7.3	19.7	35	99
1320L	1"	3/4"	27	7.3	19.7	35	77
1320M	1"1/4	1/2"	30	8.1	21.9	45	197
1320N	1"1/4	3/4"	30	8.1	21.9	45	183
1320P	1"1/4	1"	30	8.1	21.9	45	150
132011212	1"1/2	1/2"	38	12.2	25.8	52	312
1320Q	1"1/2	3/4"	38	12.2	25.8	52	303
1320R	1"1/2	1"	38	12.2	25.8	52	292
1320S	1"1/2	1"1/4	38	12.2	25.8	52	202
1320T	2"	1"	36	11.2	24.8	63	382
1320U	2"	1"1/4	36	11.2	24.8	63	360
1320V	2"	1"1/2	36	11.2	24.8	63	296
1320W	2"1/2	1"	45	14.1	30.9	81	855
1320X	2"1/2	1"1/4	45	14.1	30.9	81	796
1320Y	2"1/2	1"1/2	45	14.1	30.9	81	753
1320Z	2"1/2	2"	45	14.1	30.9	81	630
132032	3"	2"	47	14	33	95	1041
13203212	3"	2"1/2	47	14	33	95	767
132042	4"	2"	52	12	40	120	1993
13204212	4"	2"1/2	52	12	40	120	1631
132043	4"	3"	52	12	40	120	1493